

Bear Pendant Top

Level: Basic/ Intermediate



Completed piece

<Materials>

Art Clay Copper Clay Type	10g
---------------------------	-----

<Tool>

Cooking sheet, roller, plastic strips 1.5mm thick, plastic strips 1mm thick, rubber block, plastic case, spatula, red sponge sanding pad (#320-600), tweezers, stainless steel brush long bristles, burnisher, pickling compound, baking soda, stainless bowl, needle, straw dia.4mm, glass pot, chopsticks

<Step by Step Guide>



Pattern sheet (Actual size)

Please print this out on A4 size paper.



1) Roll out the clay 1.5mm thick with a roller to make a long strip. Make fabric texture on the clay using a towel etc.



2) Place the pattern sheet on the clay and cut out the clay with the needle.



3) Open holes for eyes, and make texture of the ears, arms, legs and tail by making dents with the needle tip.

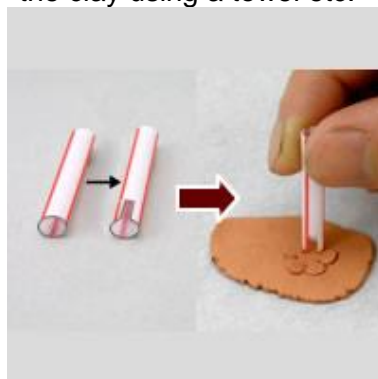

4) Cut the straw like in the image. Then, roll out the clay 1mm thick and cut out the flower petals with the straw.



5) Mix almost the same amount of water with a small amount of copper clay to make paste. Mayonnaise texture is good.



6) Make 2 small clay balls for the flower center and nose, and attach with a small amount of Paste.



7) Make a short clay rope for the flower stem. Attach them to the bear piece with a small amount of paste. After drying completely, smooth the sides and back with the red sponge sanding pad.



8) Make a pendant bail to thread through a chain by rolling out the clay into a 1mm thick band, and wrap around the 4mm diameter straw. Attach it with a small amount of paste on the back. After drying, smooth the bail with the red sponge sanding pad.



9) Fire in an electric kiln at 970C/1778F for 30minutes. After firing, cool down the piece into cold water with some tweezers to remove the oxidized film. *Before firing, prepare water in the bowl next to the kiln.



10) Pickle the piece with some pickling compound. Then, neutralize the fired piece with some baking soda and water.



11) Polish with a stainless steel brush and burnisher. Attach the chain and finish.



Tip: Oxidized film will be made on copper clay due to exposure to the air. The best storage method to prevent oxidized film is by wrapping the copper clay and plastic wrap tightly without any air pockets and then roll out the clay with a roller to bind them more closely together.